

DIMENSIONS & RECOMMENDED PATTERN

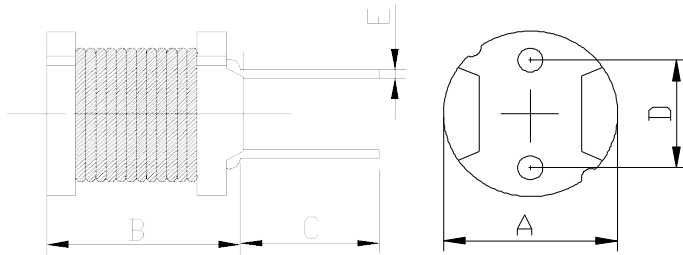

A: 7.8±0.5	mm
B: 9.5 Max.	mm
C: 15±2.0	mm
D: 5.0±0.5	mm
E: φ0.65±0.1	mm

※FEATURE

Applications:DC-DC converters,LCD Set,OA equipment,notebook, PDA

SELECTION GUIDE FOR STANDARD COILS:

MAGLAYERS PT/NO.	Inductance L(μH)	Percent Tolerance	Test Frequency	Resistance RDC(Ω)Max.	Rated DC Current
					IDC1(A)
GDR-895C-100	10	M	100kHz/0.25V	40m	2.6
GDR-895C-150	15	M	100kHz/0.25V	50m	2.1
GDR-895C-220	22	M	100kHz/0.25V	60m	1.7
GDR-895C-470	47	K,M	100kHz/0.25V	0.10	1.3
GDR-895C-560	56	K,M	100kHz/0.25V	0.11	1.2
GDR-895C-221	220	K,M	100kHz/0.25V	0.38	0.64
GDR-895C-471	470	K,M	100kHz/0.25V	0.89	0.43
GDR-895C-561	560	K,M	100kHz/0.25V	1.01	0.40
GDR-895C-102	1000	K,M	100kHz/0.25V	1.84	0.30
GDR-895C-152	1500	K,M	10kHz/0.25V	2.80	0.23
GDR-895C-222	2200	K,M	10kHz/0.25V	4.21	0.19
GDR-895C-332	3300	K,M	10kHz/0.25V	6.16	0.15
GDR-895C-103	10000	K,M	10kHz/0.25V	22.0	89m
GDR-895C-473	47000	K,M	10kHz/0.25V	96.4	38m

※GENERAL SPECIFICATION:

※ 1. □ Specify the inductance tolerance, K(±10%), M(±20%)

※ IDC1 : Based on inductance change (ΔL/Lo : drop 10% Max.)@ ambient temp. 25°C

IDC2 : Based on temperature rise (ΔT : 40°C TYP.) Rated

DC Current : The less value which is IDC1 or IDC2.